

# RECHARGEABLE SEALED LEAD ACID BATTERY

# SPECIFICATION

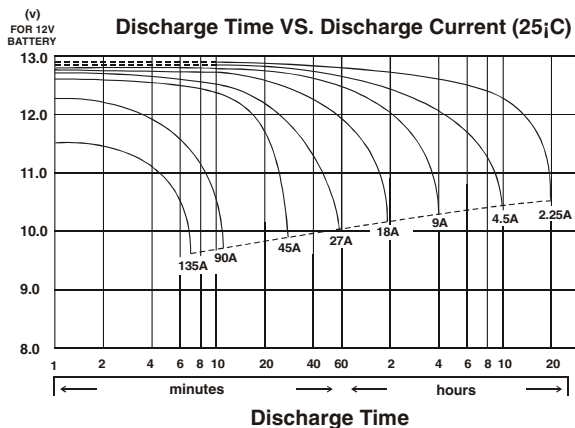
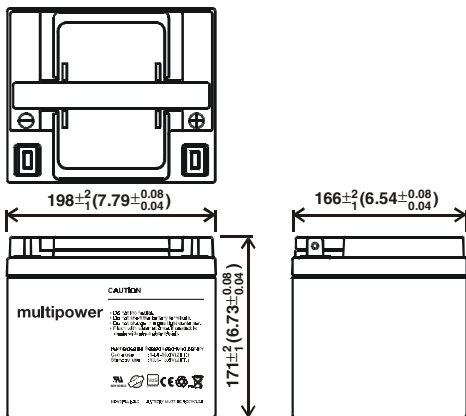
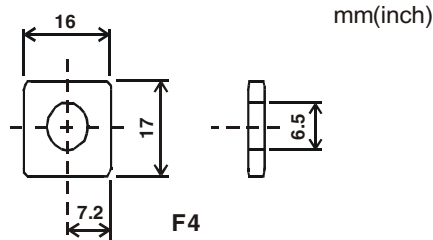

## MP45-12

**Nominal Voltage (V)** 12V

**Nominal Capacity**

20hour rate ( 2.25A to 10.50V )	45Ah
10hour rate ( 4.5A to 10.50V )	45Ah
5hour rate ( 7.65A to 10.20V )	38.25Ah
1C ( 45A to 9.60V )	20.25Ah
3C ( 135A to 9.60V )	16.2Ah

**Weight** 14.109kg(31.04Lbs.)

**Internal Resistance (at 1KHz)** 6 mΩ

**Maximum Discharge Current for 30 seconds :** 900A

**Maximum Discharge Current for 5 seconds :** 1800A

### Operating Temperature Range

Charge	0°C (32°F) to 40°C (104°F)
Discharge	-15°C (5°F) to 50°C (122°F)
Storage	-15°C (5°F) to 40°C (104°F)

### Charge Retention (shelf life) at 20°C (68°F)

1 month	92%
3 month	90%
6 month	80%

### Charging Methods at 25°C (77°F)

**Cycle use:**  
 Charging Voltage 14.4 to 15.0V  
 Maximum Charging Current: 13.5A

**Standby use:**  
 Float Charging Voltage 13.50 to 13.80V

### Life expectancy :

**Cycle Use:**  
 100% depth of discharge 200 cycles  
 80% depth of discharge 225 cycles  
 50% depth of discharge 500 cycles

**Standby Use:** 3-5 years

**Case Material** ABS  
 (Option: 94-HB & 94V-0 flame retardant case)

**Terminal** F4